

APH 450



EXPERIENCE DIGITAL REFRACTION DIFFERENTLY



APH 450

AUTOMATIC REFRACTOR



Optometry



EXPERIENCE DIGITAL REFRACTION DIFFERENTLY

The **APH 450** is a motorised phoropter that will appeal to practitioners experienced with manual refractors as well as those already familiar with automatic systems. With its innovative tablet-driven interface, it adapts to every refracting situation, streamlining workflow while enhancing your expertise in the refraction room.



WIRELESS CONNECTIONS

- + The system is programmed for immediate integration and use via wireless connectivity.
- + The installation is simple - with no wiring required.

VERSATILE FOR AUTO OR MANUAL USE

- The APH 450 application is highly intuitive with easily-accessible commands all grouped onto one screen. It adapts to every working method with a choice of two operating modes:
- **Manual Operation Mode** performs all routine manual refraction tasks and provides the traditional practical experience to users more comfortable with a manual phoropter.
- **Auto Operation Mode** offers a more streamlined refraction sequence following pre-programmed steps, giving you more freedom of movement.

FASTER REFRACTION PROCESS

- Phoropter and vision test chart can be controlled in one screen, significantly reducing total refraction time.
- Entering data from a lensmeter or AKR, the system ensures refraction starts as close as possible to the final prescription.
- Allows you to compare new and old prescriptions at the touch of a button.

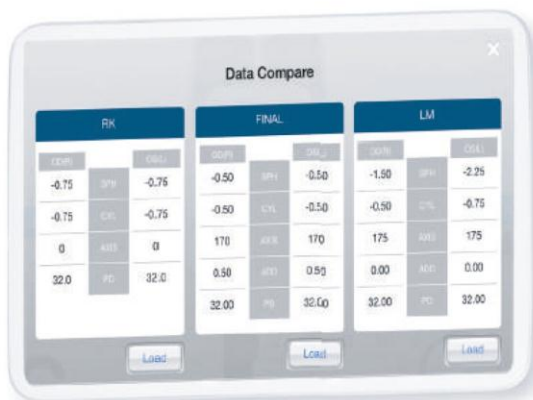

A PROFESSIONAL EXPERIENCE

- Freed from time-intensive manual refraction, you can focus more on your patients during the exam.
- You control the entire refraction process at a comfortable distance from your patient.
- The tablet also offers a convenient way to share information and results instantaneously with patient.

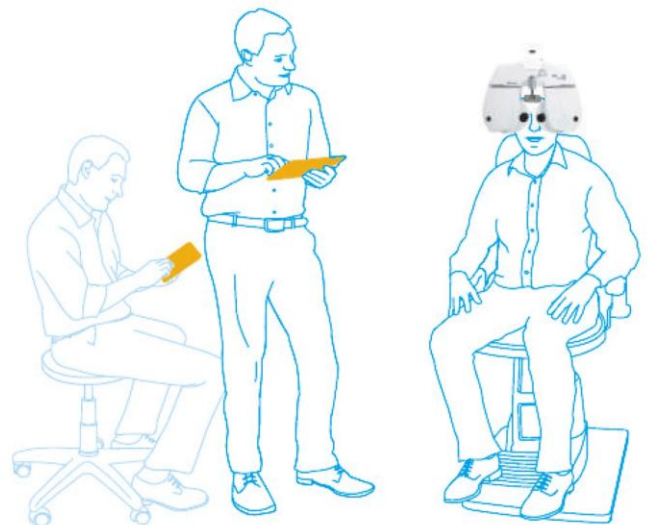

OPTIMISED EXAMS AND FOLLOW-UP



Customisable refraction sequences

Automated functions and quick exam protocols to optimize your personal test requirements and fit individual needs.

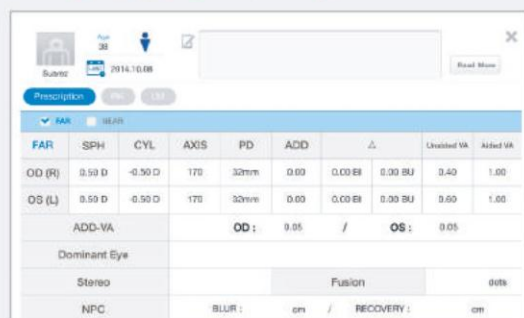

Customer database

Refraction data can be easily saved to facilitate ongoing monitoring of patients.

COMPATIBLE CHART SYSTEMS



CS 450



CS 200

	CS 450	CS 200
SCREEN SIZE	LCD SCREEN 19"	CHART PROJECTOR
BRIGHTNESS/CONTRAST	250 Cd/m ² - Contrast from 100% to 1%	
PROJECTION DISTANCE	2 to 6 m	2 to 7 m (3m recommended)
TESTS	Letters, Numerals, Snellen, Landolt rings, Ranges for children.	Letters, Numerals, Snellen, Landolt rings, Ranges for children.
Optotypes		
Visual functions	Astigmatism, Cross-cylinder, Cross-grid, Worth for dot, Amsler grid test, Clock Dial, Binocular balance, Duochrome balance, Coincidence, Schober, Phoria, Lines (Horiz./Vert.), Minute stereo, Fixation point, Colour Visio, Eye Picture, Eyeball exercise, Child animation.	Astigmatism, Cross-cylinder, Cross-grid, Worth for dot, Binocular balance, Duochrome balance, Coincidence, Schober, Phoria, Lines (Horiz./Vert.), Minute stereo, Fixation point, Eye picture.
DIMENSIONS AND WEIGHT	475(W) mm x 432(H) mm x 71(D) mm - 5 kg	204(W) x 260(H) x 313(D)mm - 3.8kg
POWER SUPPLY	100 - 240 V AC 50/60 HZ CE marking conformity	AC 100 - 240V, 50/60 Hz CE marking conformity
MEASURING RANGE	APH 450	AUXILIARY LENS
Pupillary distance	48 ~ 80 mm	Red/green filter
Sphere	-29.00 D ~ 26.75 D (0.12/0.25/0.5/1.0/2.0/3.0 D)	Polarising filter
Cylinder	-8.75 D ~ + 8.75 D (0.25/0.5/1.0/2.0/3.0 D)	Prism
Axis	0° ~ 180° (1° / 5°)	Rod Maddox (Horiz./vertic.)
Prism	0 ~ 20 Δ (0.1/0.2/0.5/1 /2 Δ)	Lens for retinoscopy
CONVERGENCE (NEAR-VISION)	•	Cross cylinder (±0.50D)
DIMENSIONS AND WEIGHT	370(W) x 82(D) x 299/358(H) mm - 4kg	Pin hole
		POWER SUPPLY
		DC 24 V 60 W 50 / 60 Hz CE marking conformity

PRODUCT FUNCTIONS



Measurement range
- sphere and cylinder



Measurement range -
Prism



Polarisation



Cross cylinders



Wireless data
transfer



Instruments Division
64 bis, avenue Aubert
94306 Vincennes Cedex France
Tel: 33 (0)1 72 94 71 00
Fax: 33 (0)1 72 94 70 27
www.essilor-instruments.com

Your contact:

Loyal tech group LTD
www.loyaltech.com.hk
info@loyaltech.com.hk